

## 1500L Emergency Tank Shower - Immersion heated

### EXP-MH-14KS/1500

Meet EN-15154-5 and ANSI 358.1 standards whilst protecting your workforce at risk of contamination from hazardous substances. This 1500 litre gravity fed tank shower is fully operational in temperatures down to -35°C. Featuring a self-contained tank there is no need for a mains water supply making this the best solution for remote locations.

The integral immersion heater and thick polyurethane insulation maintain the temperature of the water within the overhead tank between 15°C-38°C. At this tepid temperature the casualty is able to remain under the shower for the minimum 20 minutes to decontaminate thoroughly.



## Specifications

MATERIALS OF CONSTRUCTION	
FRAME AND LEGS	Polished stainless steel
WATER TANK	1500 L (396 US gal) capacity medium density polyethylene MDPE
TANK SURROUND AND LID	GRP
INSULATION	40mm (1 1/2") foil backed polyurethane
PIPING AND VALVE	uPVC and stainless steel
SHOWER CONTROL VALVE	uPVC 1 1/2" ball valve
EYE WASH CONTROL VALVE	1/2" stainless steel full flow ball valve
EYE WASH STRAINER	1/2" stainless steel
BALLCOCK VALVE	2 x 1/2" brass
OVERFLOW	1" male uPVC
SHOWER ROSE	ASA (Acrylonitrile Styrene Acrylate) and stainless steel
PANIC BAR	Red powder coated stainless steel
FOOT CONTROL OPTIONS	GRP panel (for shower) and powder coated stainless steel treadle (for eye wash)
FASTENERS AND FIXINGS	Stainless steel
SERVICES	
ELECTRICAL EQUIPMENT	ATEX Zone 1 & 2. Gas groups IIA & IIB. Temp Class T3 (IIC available) Non-flameproof models also available
ELECTRICAL SUPPLY	240V, single phase, 50/60Hz (110V optional)
IMMERSION HEATER RATING	3kW - 230V
WATER INLET	3/4" female BSP
OPERATING PRESSURE	0.5 to 7 BAR G / 7 to 101 PSI
MINIMUM FLOW RATES	Shower: 76 L per minute / 20 US gal per minute Eye/face wash: 12 L per minute / 3 US gal per minute
AMBIENT OPERATING TEMPERATURE	
MINIMUM	-35°C
MAXIMUM	40°C

Specifications continued overleaf

## 1500L Emergency Tank Shower - Immersion heated

### EXP-MH-14KS/1500

OPERATION	
SHOWER	Push activated panic bar or optional GRP foot panel
EYE WASH	Lift lid
DIMENSIONS & WEIGHT	
DIMENSIONS (WxDxH)	1510mm (59.4in) x 1495mm (58.9in) x 3746mm (147.5in)
WEIGHT	340kg (750lb)

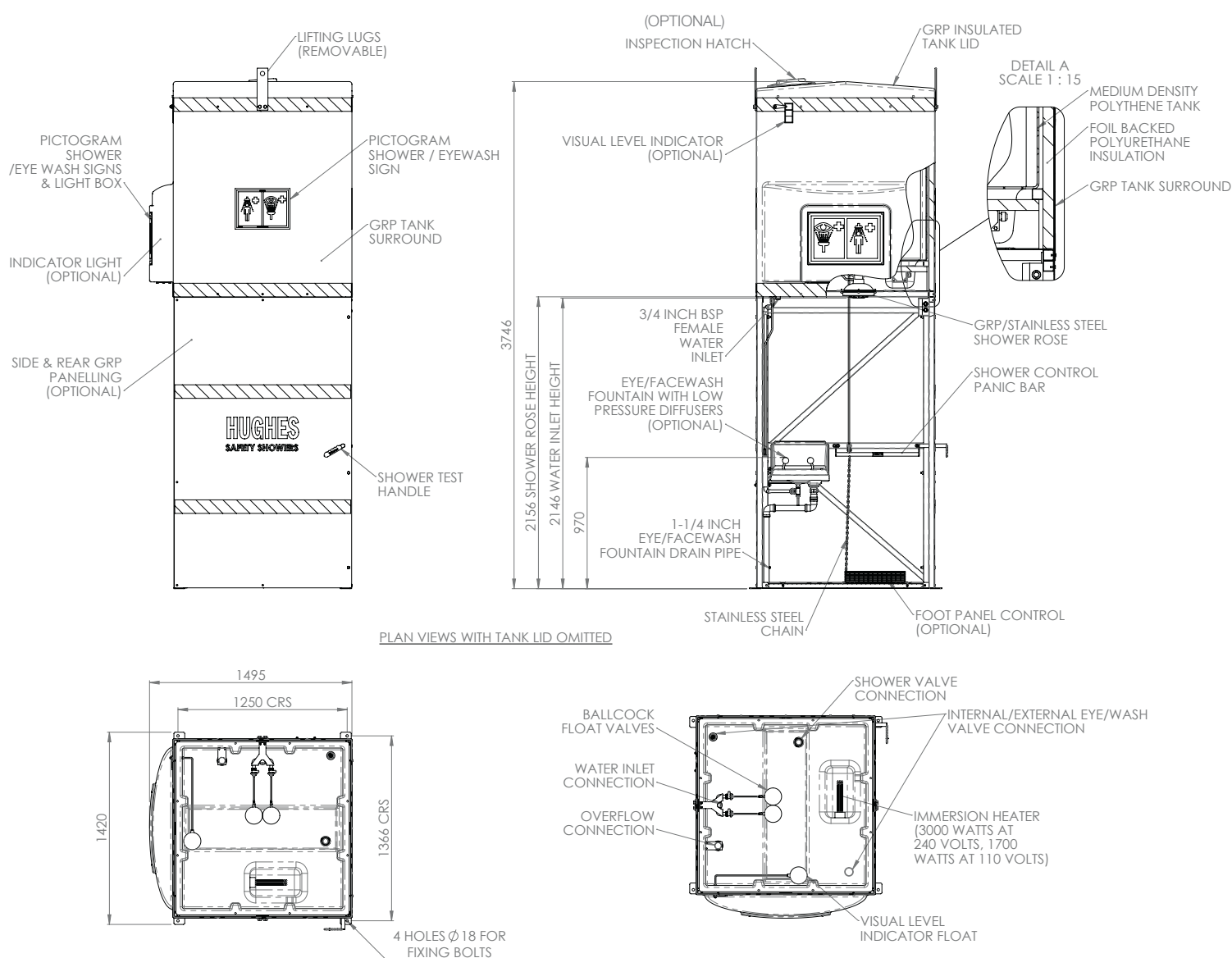

[www.hughes-safety.com](http://www.hughes-safety.com)